

PP Bag Filter Housings

- Integral moulding design. Interior finishing of the housing is smooth, making it easy to clean and maintain. Pressure resistance is up to 6 bar
- Seamless welding structure is different from regular drilling and welding process in the industry which reduce pollution during the production
- Brand new sealing design solves by-pass issue. The pressure plate avoids O-ring deformation during rotating threads on the top lid
- Filter bag ring is completely fitted with housing in good tightness which reduce by-pass effectively

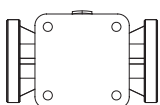

Filter Size	#1 Bag; #2 Bag; #4 Bag
Material	Polypropylene
Inlet/Outlet	1 1/2, 2, 2 1/2 inch Flange
Closure Type	Swing bolt(Swing bolt in Titanium is optional), Screw style top lid
Flow Rate	#1: Up to 20 CMH #2: Up to 45 CMH #4: Up to 10 CMH
Max. Operating Pressure	6 bar
Applications	PCB Wet Processing Equipment, Chemicals, Circulating Water

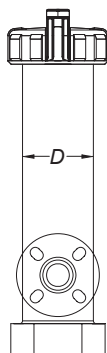
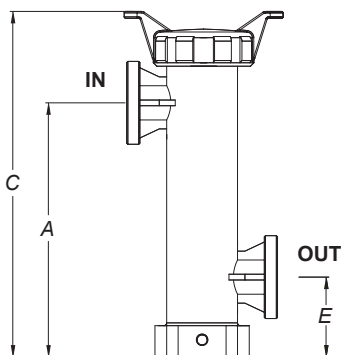
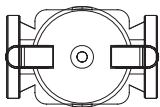

Model	A	C	øD	E
UFBH01	450	656	230	135
UFBH02	635.5	843	230	152.5
UFBH04	445	605	124	140

unit: mm